

ROAD ANGEL™

5V MINI USB HARDWIRING KIT

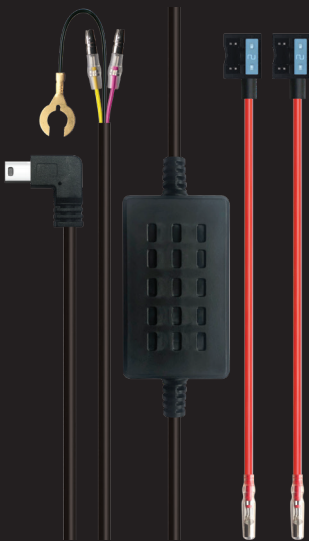

INSTALLATION GUIDE



Need Help? +44 (0)330 320 3030

RoadAngelGroup.com

What's in the box

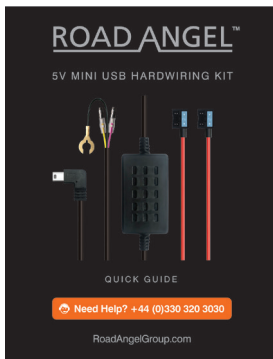
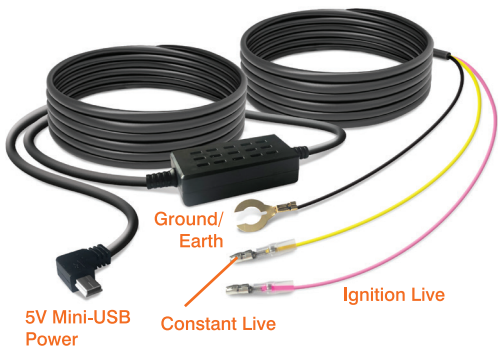

ROAD ANGEL™

x2 Mini Fuse - Fuse Tap Connector



x8 Mini Fuse Pins

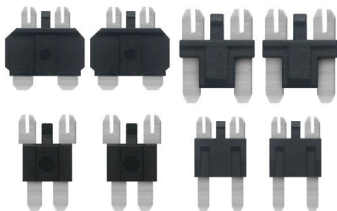

x2 2 Amp Fuses



x2 7.5 Amp Fuses



x3 Wire Clips



The Road Angel™ HWK5VIEW Hardwire Kit is designed for use with Road Angel™ Halo View and Aura HD5 that requires a Mini-USB 5V connection. This hardwiring kit requires a “switched” and “constant” power source.

Fitting instructions ¹

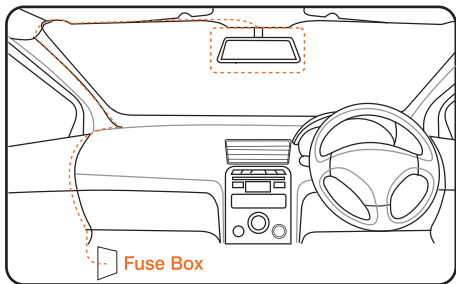

STEP 1

- Connect the Mini-USB Connector of the 5V Hardwire Kit to the Halo View/Aura HD5 Front camera. This is located at the top of the mirror.
- Gently route the cable from the top of the mirror and under the headliner.
- Route the cable towards the passenger side of the vehicle and down the A-Pillar trim panel next to the Dashboard.
- When at the bottom of the A-Pillar and lower dash, route the Halo View/Aura HD5 Power cable to the location of the vehicle fuse box (see car manual).

Fitting instructions²

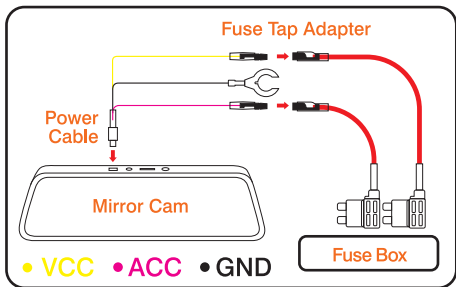

STEP 2

- There are 2 bullet connectors on the Halo View/Aura HD5 power cable - the VCC (Yellow) and ACC (Pink).
- Insert each bullet connector into the fuse tap adapters.
- Insert the connector fully and tighten the joint point using wire Crimps or Pliers.
- Ensure the insulation sleeve covers the joining points.

VCC = Constant Live: VCC Power cable (YELLOW) is referred to as a 'Constant Live' meaning power is always present even when the ignition is not on.

ACC = Ignition Live: ACC Power cable (PINK) is referred to as an 'Ignition live' meaning that the power is only present when the ignition key is turned.

Fitting instructions³

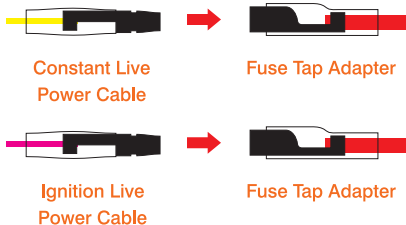

STEP 3

In the vehicle fuse box, locate and select the suitable fuse(s) to use for both the VCC (Yellow) and ACC (Pink) – The VCC (Yellow) is referred to as “Constant” or “Permanent” live. The ACC (Pink) is referred to as “Switch” or “Ignition” live

GND = Ground/Earth: GND Cable (BLACK) is referred to as ‘Ground’ or ‘Earth’ and should be attached to a screw which is attached to the body or bare metal.

Fitting instructions⁴

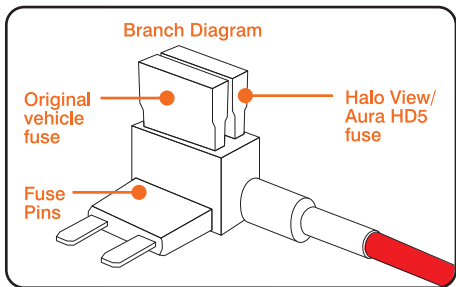

STEP 4

- The fuse tap adapter branch circuit is connected to VCC (Yellow) & ACC (Pink) wires by a fuse which protects both the Halo View/Aura HD5 and the Vehicle from voltage Damage.
- Remove the existing fuse as highlighted in (Step 3) – sometimes a fuse will not be present.
- Insert this fuse into the lower slot (Original vehicle fuse in the diagram above) of the Halo View/Aura HD5 Fuse Tap adapters.
- Insert the supplied corresponding fuses into the upper slot of the Halo View/Aura HD5 Fuse Tap adapters.
- Now insert the Halo View/Aura HD5 Fuse Tap adapters into the empty slot in the car's fuse box, thus making sure VCC (Yellow) & ACC (Pink) are in the correct locations.

ROAD ANGEL™

5V MINI USB HARDWIRING KIT



Need Help? +44 (0)330 320 3030

Illustrations and manual contents are subject to change without notice.

RoadAngelGroup.com

Designed in the United Kingdom

Designed and manufactured by Road Angel Group,
DB House, Rani Drive, Nottingham, NG5 1RF United Kingdom



Disclaimer

Road Angel Group has made every effort to ensure the information contained in this manual is accurate and reliable. However, the information is subject to change without notice. Road Angel Group assumes no responsibility for any damage or injury resulting from incorrect installation of electric devices or components. Any electrical installation should only be performed by a competent or qualified individual. Working with your vehicle's electrical system can be dangerous both to you and your vehicle.

- Ensure the ignition is off before installing the Halo View/Aura HD5 5V Hardwire Kit.
- Check the polarity and grounding is correct before testing the installation.
- Avoid using a fuse connection for a safety critical circuit, e.g. Airbag.
- Not designed for installation to positive ground circuits.
- Any modifications to the Halo View/Aura HD5 or Hardwiring kit and its supplied accessories will void the product warranty. Extension of the hardwiring is permitted to suit the vehicle type.
- The ACC (Pink) is referred to as "Switch" or "Ignition" live, meaning power is only on when Ignition is on.
- The VCC (Yellow) - is referred to as "Constant" or "Permanent" live, meaning power is always on even when the ignition has been turned off.
- Please take extra care and attention when routing all cables, ensuring all and any excess cable is neatly located out of the way and not causing obstruction, danger to the driver or operation of the vehicle.



This type of installation should be performed by a qualified and capable individual only. Please consult a professional installer for any queries or arrange a mobile installation by calling **0330 320 3030**

Other products & accessories

Scan below using your Smart phone camera.



ROAD ANGEL™